

ELECTRIC COFFEE GRINDER

電 動 咖 啡 慢 磨 機

只限家用
保存本說明書備查

FOR HOUSEHOLD USE ONLY
SAVE THIS INSTRUCTIONS
FOR FUTURE REFERENCE



台灣設計製造
Made in Taiwan

Introduction

The **PureFresh** coffee grinder is designed to offer uniform grind size for pour over / automatic drip, espresso, or percolator / French press from its solid in place conical burr ceramic grinder.

It also keeps the maximum flavor and aroma of your favorite whole coffee beans from the low speed grinding mechanism.

Simply select a grind setting and with the touch of a button, you are ready to experience a new level taste!

Grind Size Consistency

The rotating part of the ceramic grinder does not rock while rotating and that regulates uniform size of grounds to pass through.

Low Speed And Low Heat-Raise Grinding

80 rpm low speed grinding takes approximate 2 minutes for one serving while the finest grind.

Achieved by remarkable gearing reduction, it lowers down the rotating speed for less heat and noise accompanied and raises the power for grinding.

20 grams of coffee beans takes less than 2 minutes to grind.

Easy Access To Clean The Ceramic Grinder

Ceramic grinder includes a stationed part and a rotating part.

The advanced design in configuration offers the easy access to clean both parts and the housings around that almost all the other electric coffee grinders cannot do.

17 Settings For Grind Size Selection

Variety of selections ensures you to find the proper grind size as wish.

Compact Size And Light Weight

22 cm (9 inch) height and 628g (22ounces) weight only.

Low Power Consumption

DC 12V power supply and less than 25 watt. power consumption.

Important Safeguards

1. READ ALL INSTRUCTIONS.
2. To protect against risk of electrical shock, do not immerse the mill with AC adaptor in water or other liquid.
3. Close supervision is necessary when any appliance is used by or near children.
4. Unplug from outlet when not in use, before putting on or taking off parts, before removing coffee and before cleaning.
5. Avoid contacting moving parts.
6. Do not operate any appliance with a damaged cord or plug, or after the appliance malfunctions, or is dropped or damaged in any manner.
7. The use of attachments not sold along with PureFresh coffee mill may cause fire, electrical shock, or risk of injury.
8. Before washing, the electric motor should be taken off parts.
9. Do not let cord hang over edge of table or counter, or touch hot surfaces.
10. Before using, check hopper for presence of foreign objects.
11. Use this appliance to grind roasted coffee beans only. Grind other substances, such as nuts, spices or unroasted beans, may dull the ceramic grinder and cause poor grinding or injury.
12. Do not use appliance for other than intended use.
13. Do not place this appliance on or near a hot gas or electric burner, or in a heated oven.
14. Except for coffee beans, if other items are put in, the protection mechanism will be started, and the device will be stopped. If the coffee grinder needs to be operated again, please take out the items, reinsert the adapter, and restart the power.

PureFresh Overview

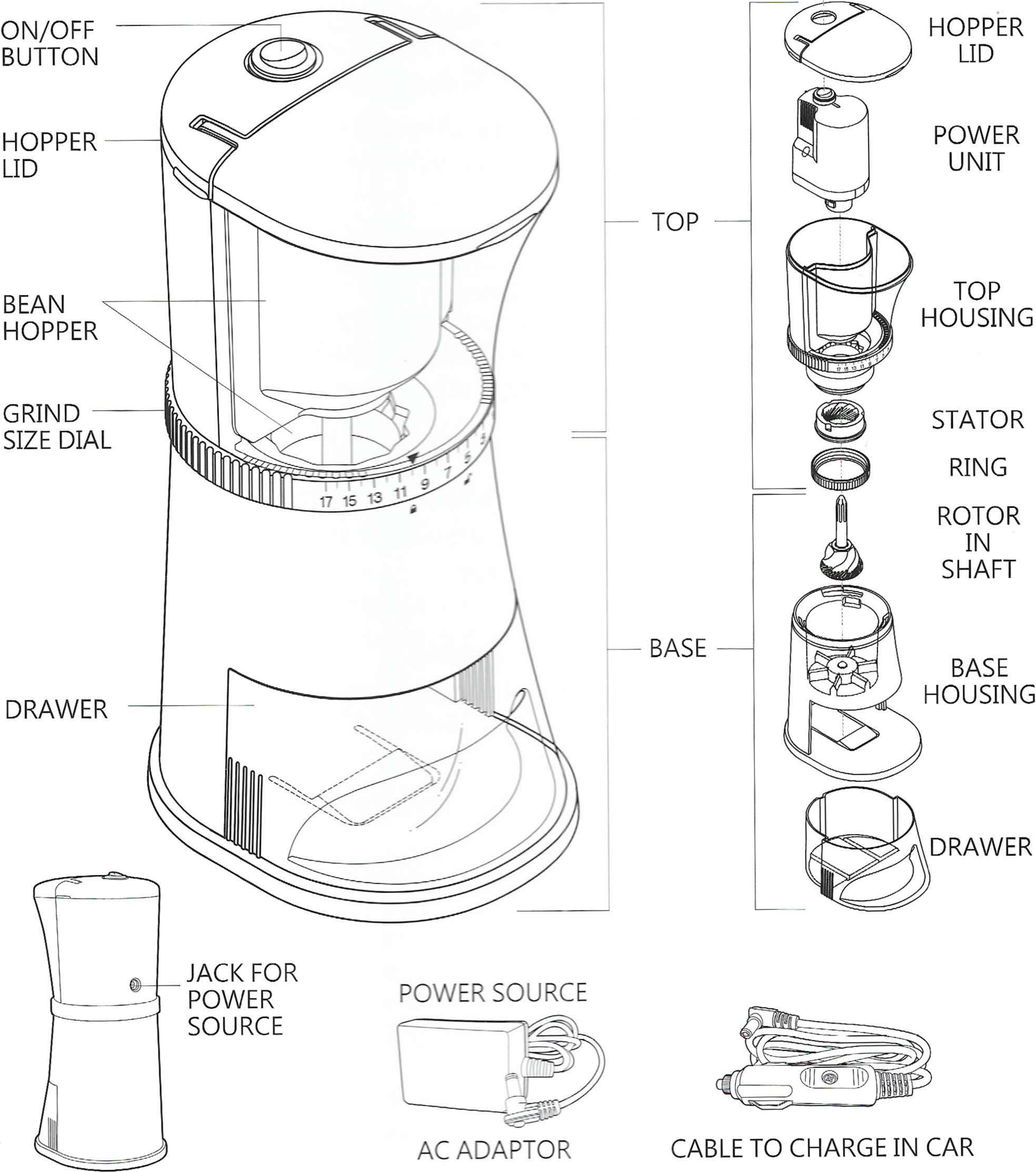

Operating Instructions

1. **Flip** bean hopper lid until it sits on the switch button.

NOTE The hopper lid when flipped open is designed to sit on the button and it can switch the button from " | " to " ○ " if sits harder.

2. **Pour** beans into hopper then replace the lid.

NOTE Max fill is about 70 grams (2.5 ounces).

When take one serving at a time, suggest to pour beans of one serving (18 ~ 35 grams) into hopper only.

Always run the grinder until out of beans in each operation.

Beans left in hopper, broken beans retained in ceramic grinder and grounds held in drawer are in contact with air and start losing the original flavor and the taste of coffee.

TIPS Grind out beans in each grinding.
Always keep hopper and drawer empty after use.

3. **Plug** the AC adaptor to outlet and connect the terminal to the jack in grinder.

4. Twist the dial to select grind size.

One hand holds the grinder from the top while the other hand twists the dial to align the selected setting with the marking " ▼ " above the dial.

To determine the right grind, experiment with different grinds and coffee types to suit your taste.

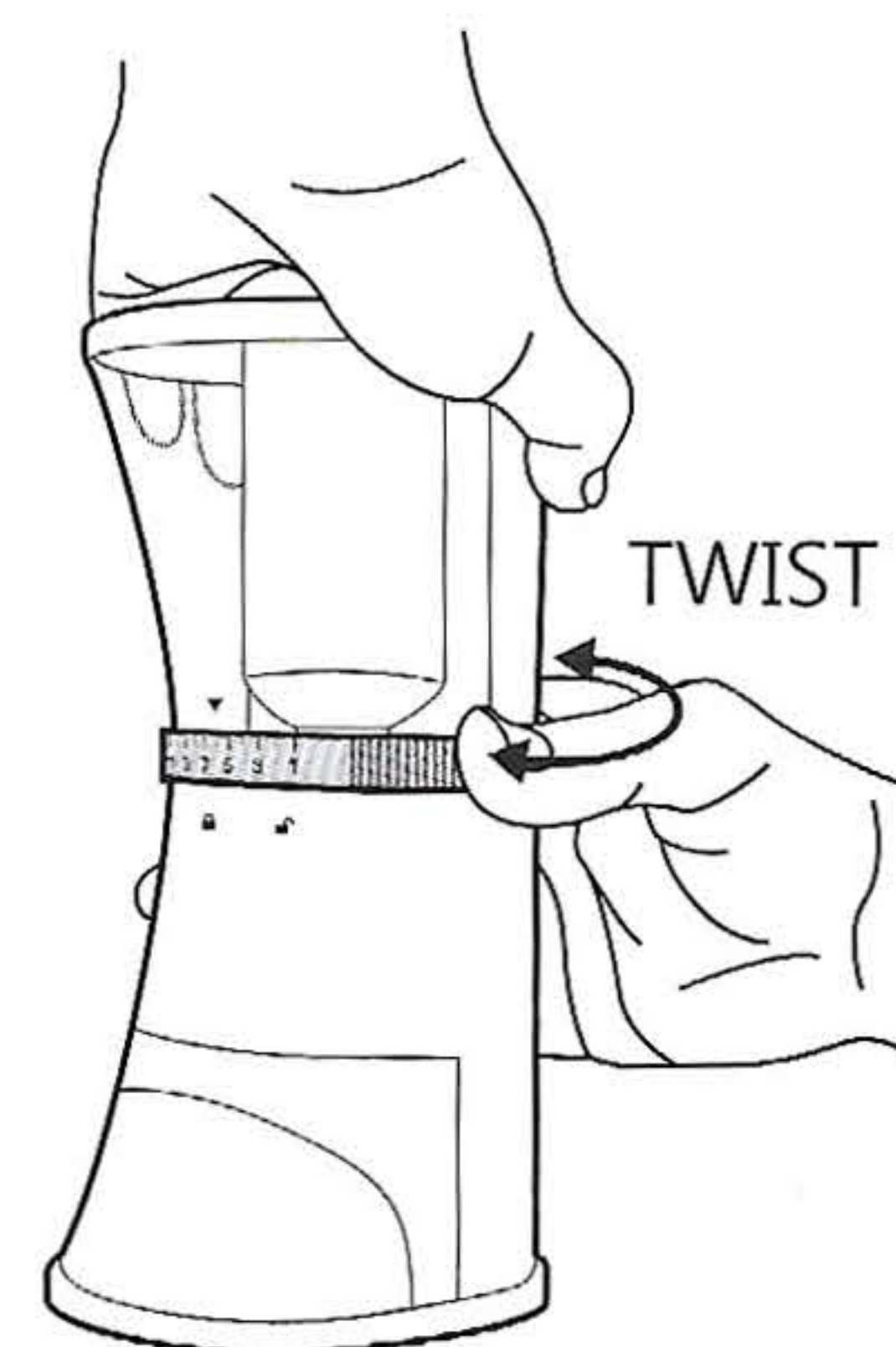

PureFresh is available with three versions and which only differ in the performance of the finest grind.

STANDARD /NEW PROFESSIONAL STANDARD

Select coarse grind for percolator / French press, medium grind for pour over / automatic drip, and fine grind for espresso.

17 settings from 1 ~ 17.

Setting 1 turns out the finest grind and the coarse grind when choose settings 17.

POUROVER SPECIAL

Settings 1 turns out the grind size suitable to pourover, not as the finest grind from setting 1 in standard **PureFresh**.

5. **SMALL AMOUNT OF GRINDING**

After grinding and brewing, then start next grinding.



SINGLE CUP

18 g ~ 35 g

DOUBLE CUP

36 g ~ 70 g

Set a cup of 250ml pour-over coffee as an example.

LARGE AMOUNT OF GRINDING

Grind coffee in multiple times also pay attention to the motor and ceramic grinder temperature. It is recommended to grind for 5 minutes and stop for 10 minutes (double time).

Grind French or Italian dark roasted beans for 12 minutes and stop for 30 minutes.



Take out the power unit

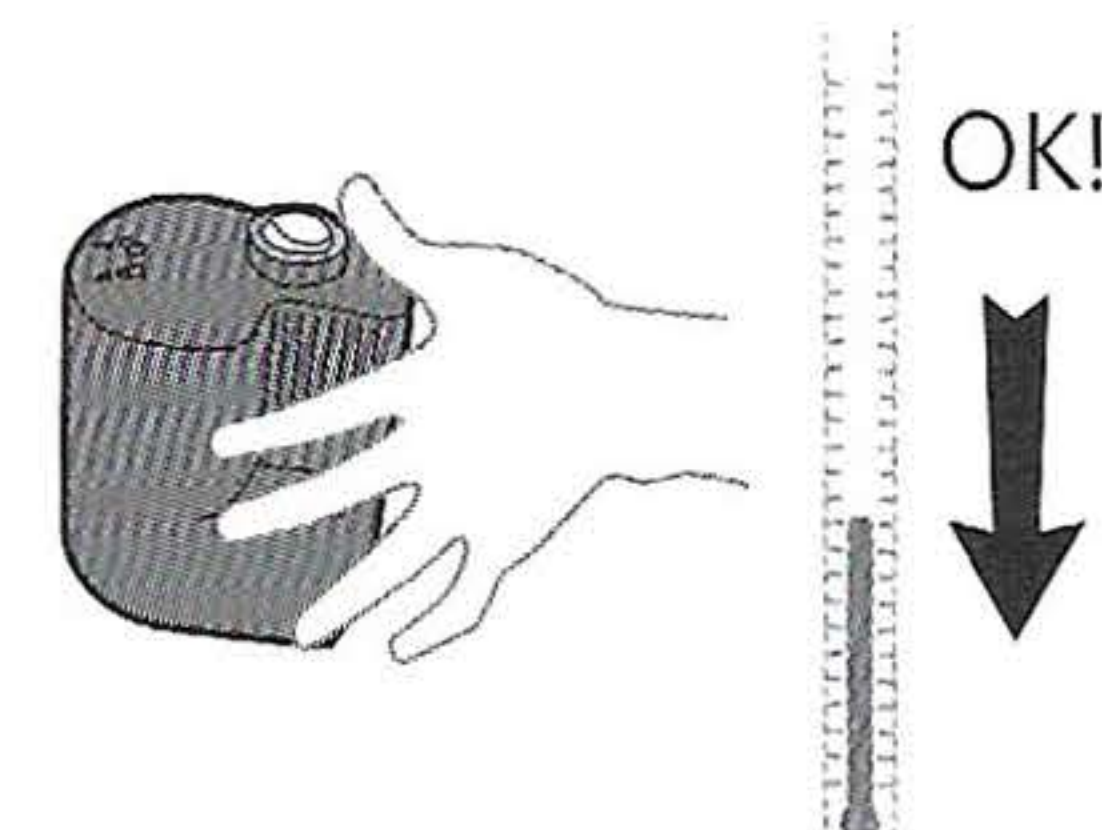

The motor and ceramic grinder needs to be paused, when temperature of the power unit is hot, and it can be used again, when recovers to room temperature.

★NEW PROFESSIONAL STANDARD

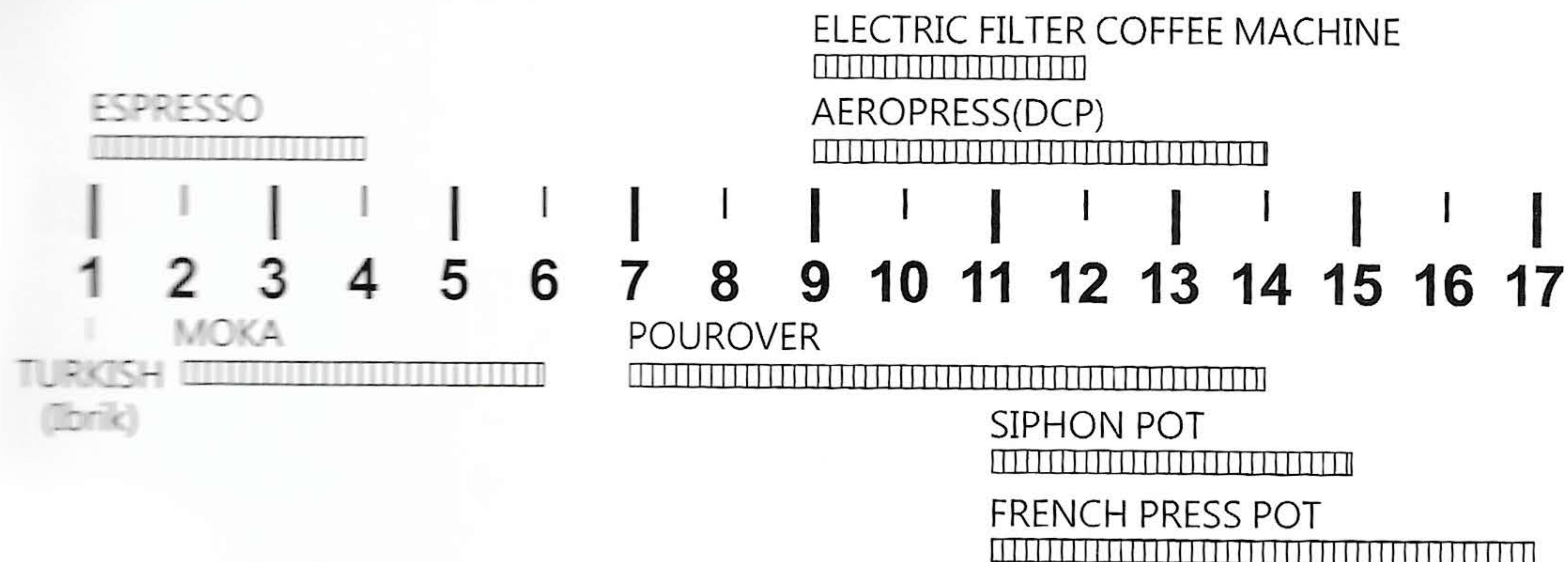

EXAMPLE Setting 7~14 stands for the grind size suitable to pourover.

STANDARD PureFresh

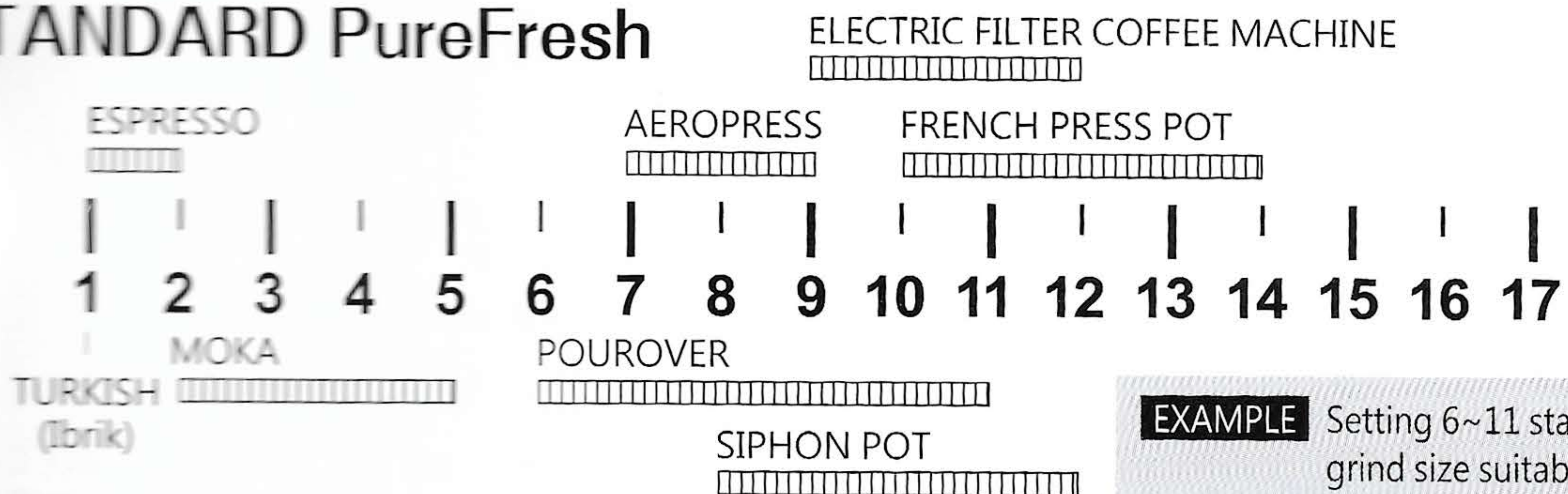

EXAMPLE Setting 6~11 stands for the grind size suitable to pourover.

POUROVER SPECIAL

(Grind Size Not Available For ESPRESSO / TURKISH / MOKA)

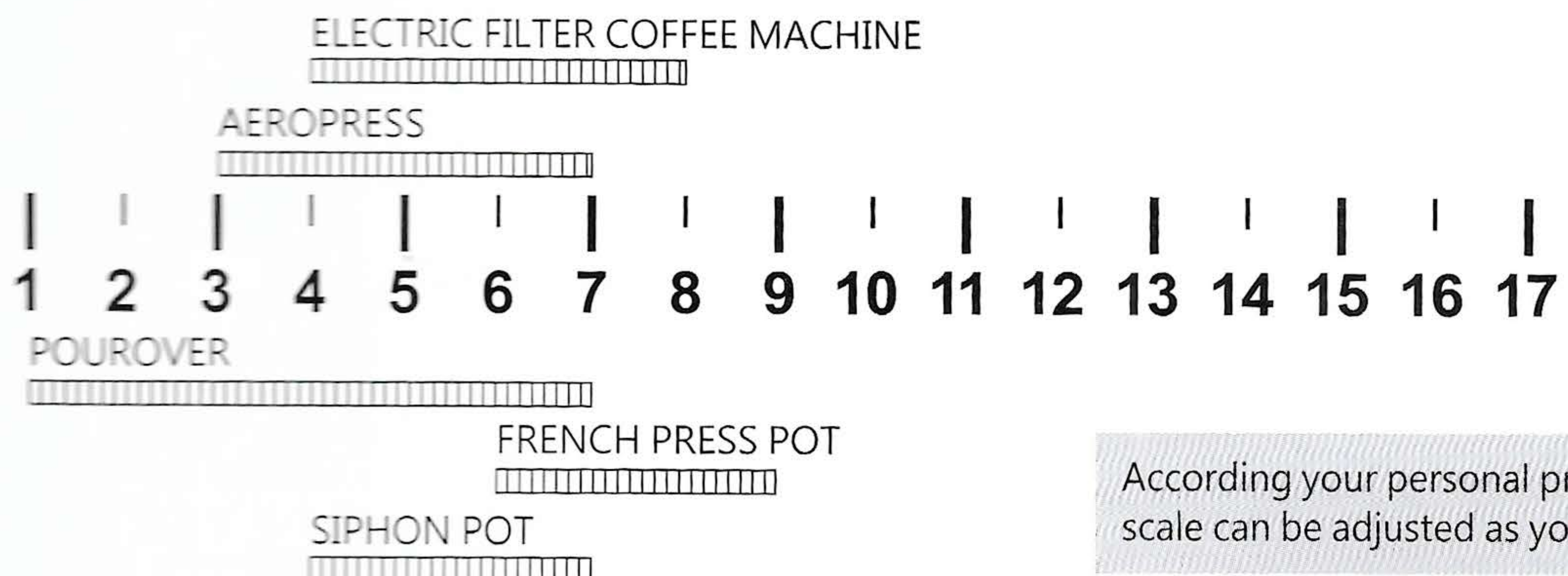

According your personal preference, the scale can be adjusted as your needs.

6. Press **I** on the switch button to begin grinding.
The button will light up.

7. Press **O** on the switch button to stop grinding.

NOTE Suggest to grind out all beans in hopper then switch off.

8. Pull out the drawer, make coffee, and enjoy !

NOTE Suggest to empty the drawer after each use.

9. During use, if the motor is powered off or stopped due to continuous high temperature or excessive hard foreign matter caused by abnormal continuous use, wait for normal temperature and make sure foreign matter to be removed before continue.

Cleaning

The oil contained within coffee bean will build up over the ceramic grinder.

Periodical cleaning at the grinder is recommended.

The ceramic grinder includes a stator and a rotor and stator locates in the top section while rotor is in the base section.

NOTE Instructions Before Cleaning

1. Be sure that the adaptor has been disconnected from outlet and jack.
2. Never immerse the power unit in water or other liquids.
3. All removable parts, except the power unit, are dishwasher safe on the top rack.
Do not put parts on bottom shelf.
4. Any other serving of this product should be performed by an authorized service representative.

Cleaning at Ceramic Grinder

Figure A
access the
ceramic grinder

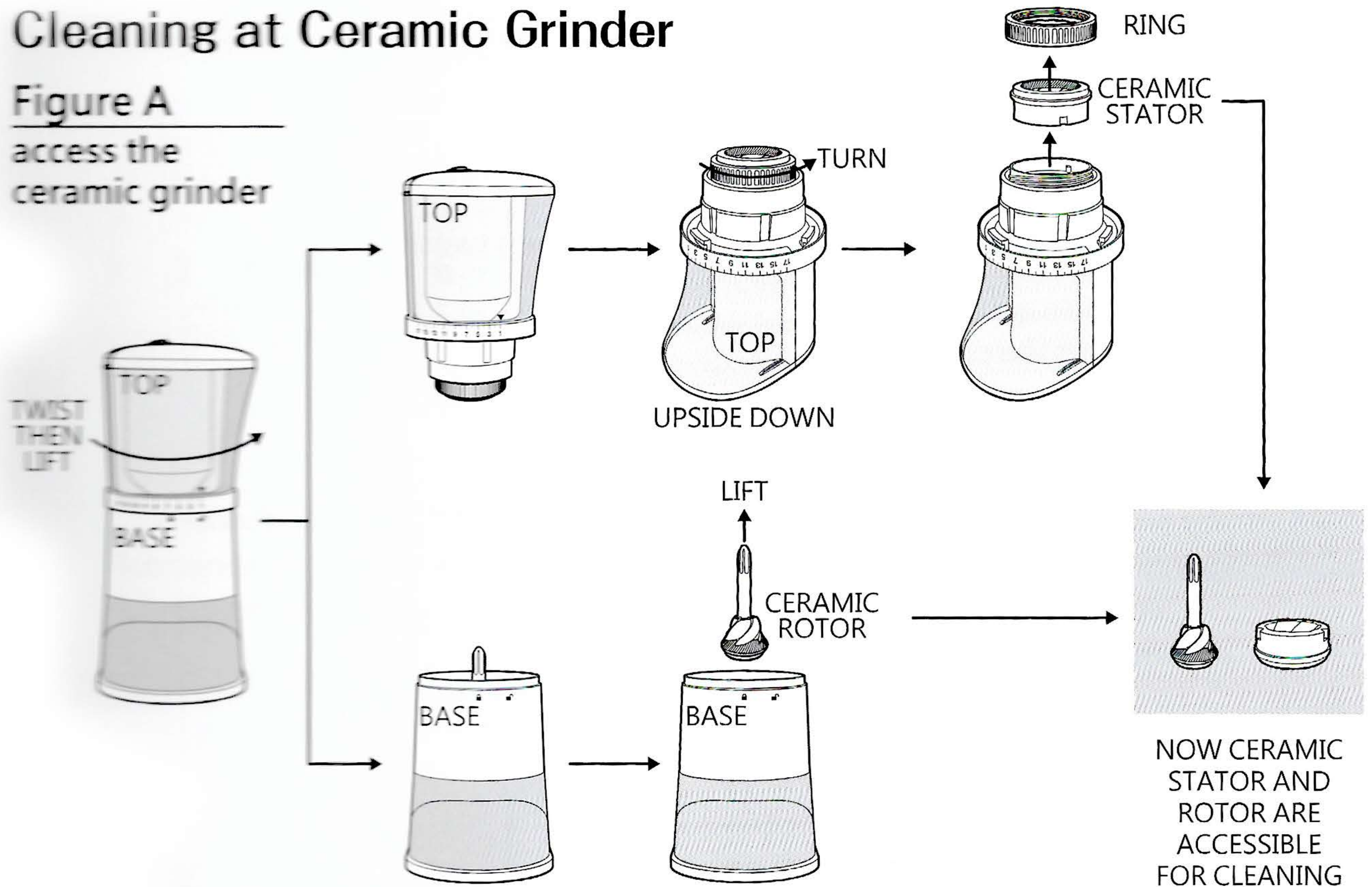

Access The Ceramic Stator

First, twist the top until stops in the index of "  " symbol. Then, lift the top from the base and turn it upside down on table top, turn the ring anticlockwise until it comes off from the bottom end of the top, now, can take the ceramic stator out.

NOTE Turn the top upside down to access the ceramic stator is the way to keep ceramic stator safe from dropping incidentally and broken.

Access The Ceramic Rotor

Ceramic rotor is mounted with a transmission shaft and is not designed to be taken out of the shaft.

Cleaning

Use cleaning brush to clean ceramic grinder.

WARNING Please oil with the Vaseline at white ceramic center cone after cleaned. It will reduce abrasion and increase service life. If used 2 times a day as an example, apply about once every 2 weeks, and increase or decrease the number of times according to use or cleaning.

Cleaning at Other Parts

Figure B
remove the
power unit

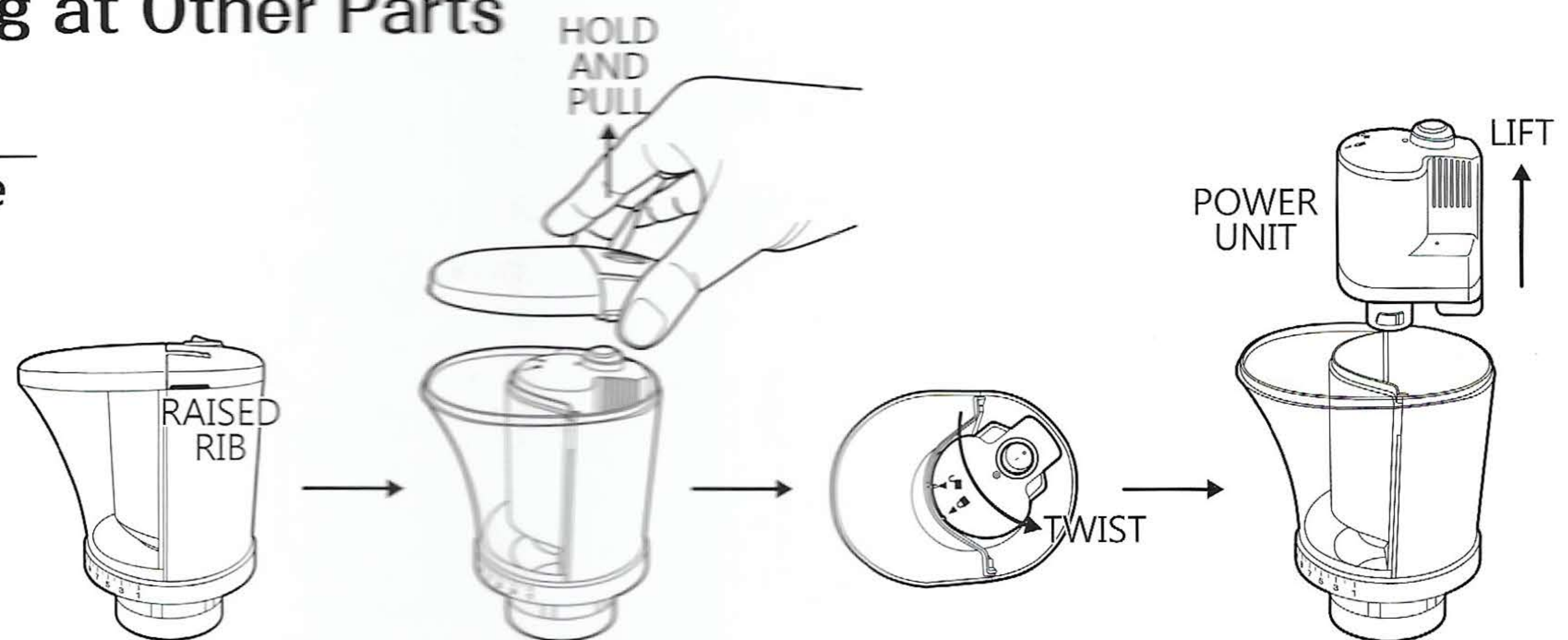

Power unit inside the top can be removed.
First, grab the lid between fingers by catching both raised ribs and pull it off the top.
Then, twist the power unit until stops and pull it out of the top.
Now, the top is apart into lid, hopper, power unit, ring and ceramic stator and they are dishwasher safe except the power unit.



NEVER IMMERSE
THE POWER UNIT
INTO WATER

Figure C
parts
diagram

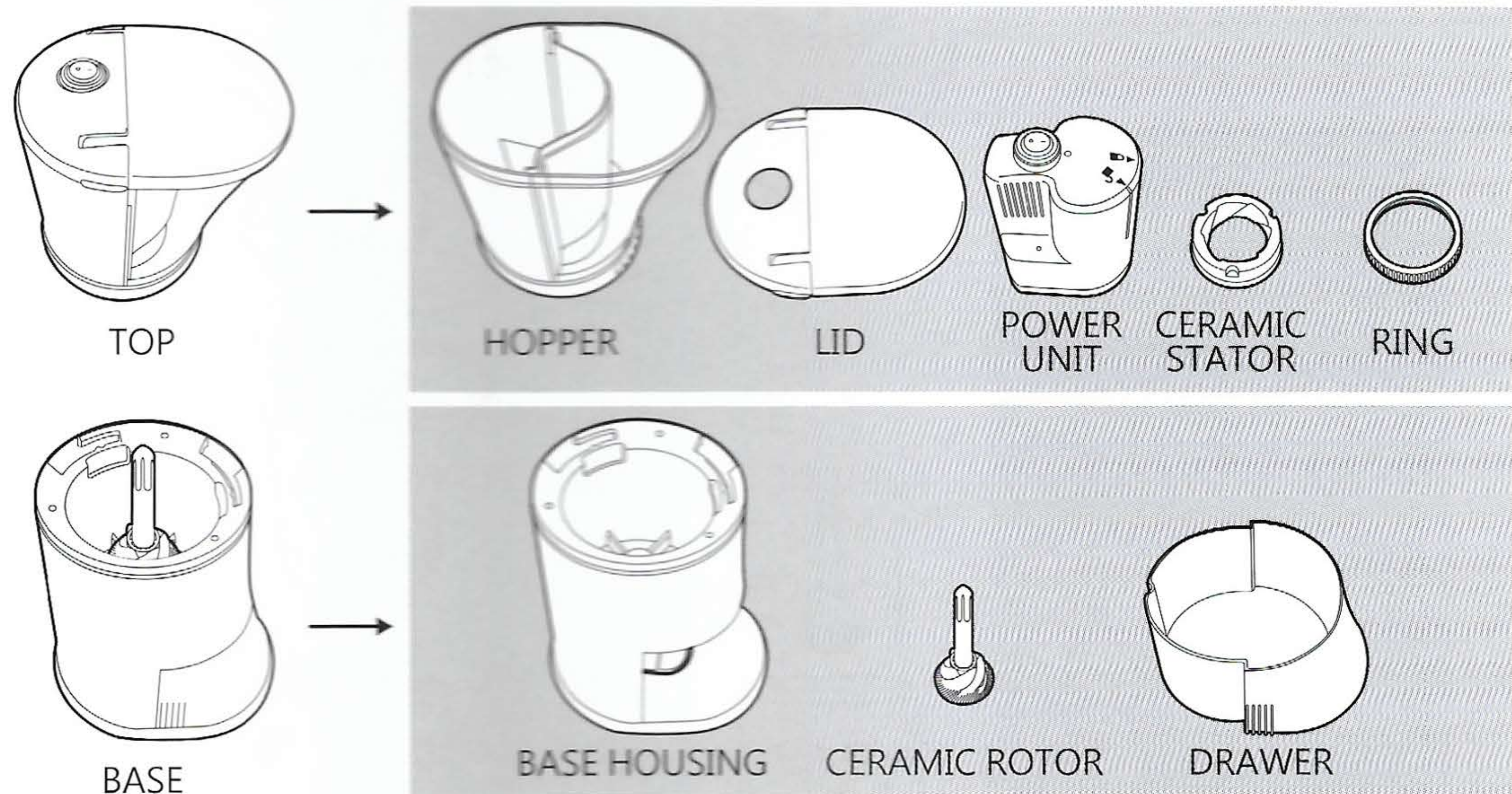

And, the base can be apart into base housing, ceramic rotor and drawer.

NOTE

Above parts are all dishwasher safe, except the power unit.

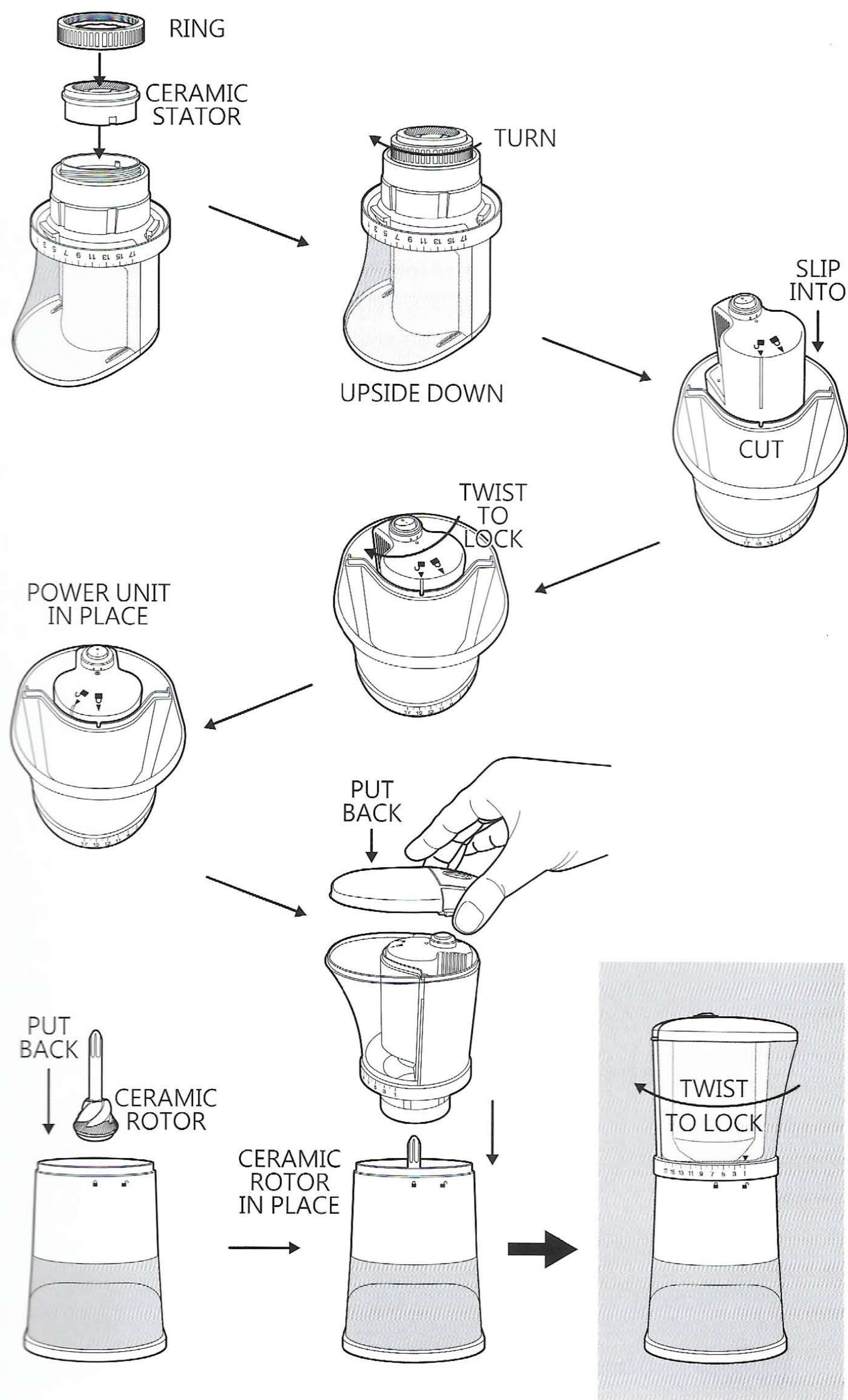

Put All Parts Together

Figure D
put back
together

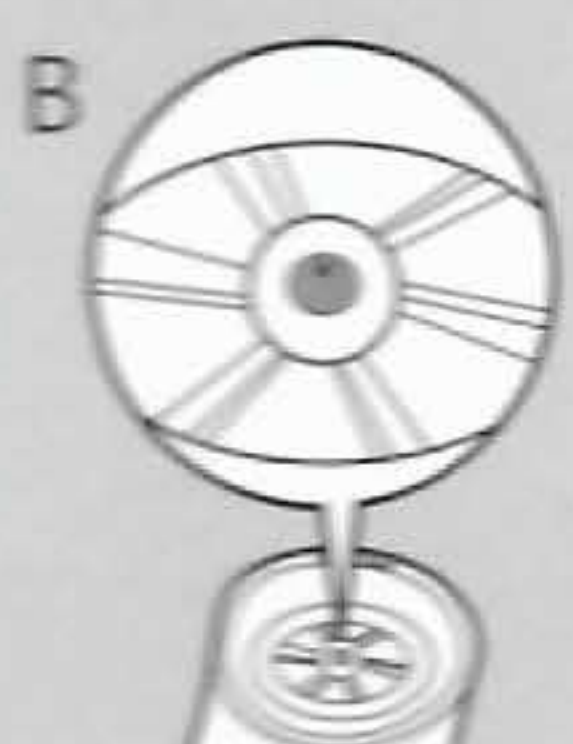

OIL MAINTENANCE REQUIRED

Please oil the gray part at figure A regularly. If white ceramic center cone (gray part in figure B) has white powder, it means the ceramic is worn and must be oiled.



A **B**



Oil the gray parts with little bit Vaseline.

Put The Top Back Together

Ceramic stator has 3 coves around the edge and there are 3 short ribs around the opening.

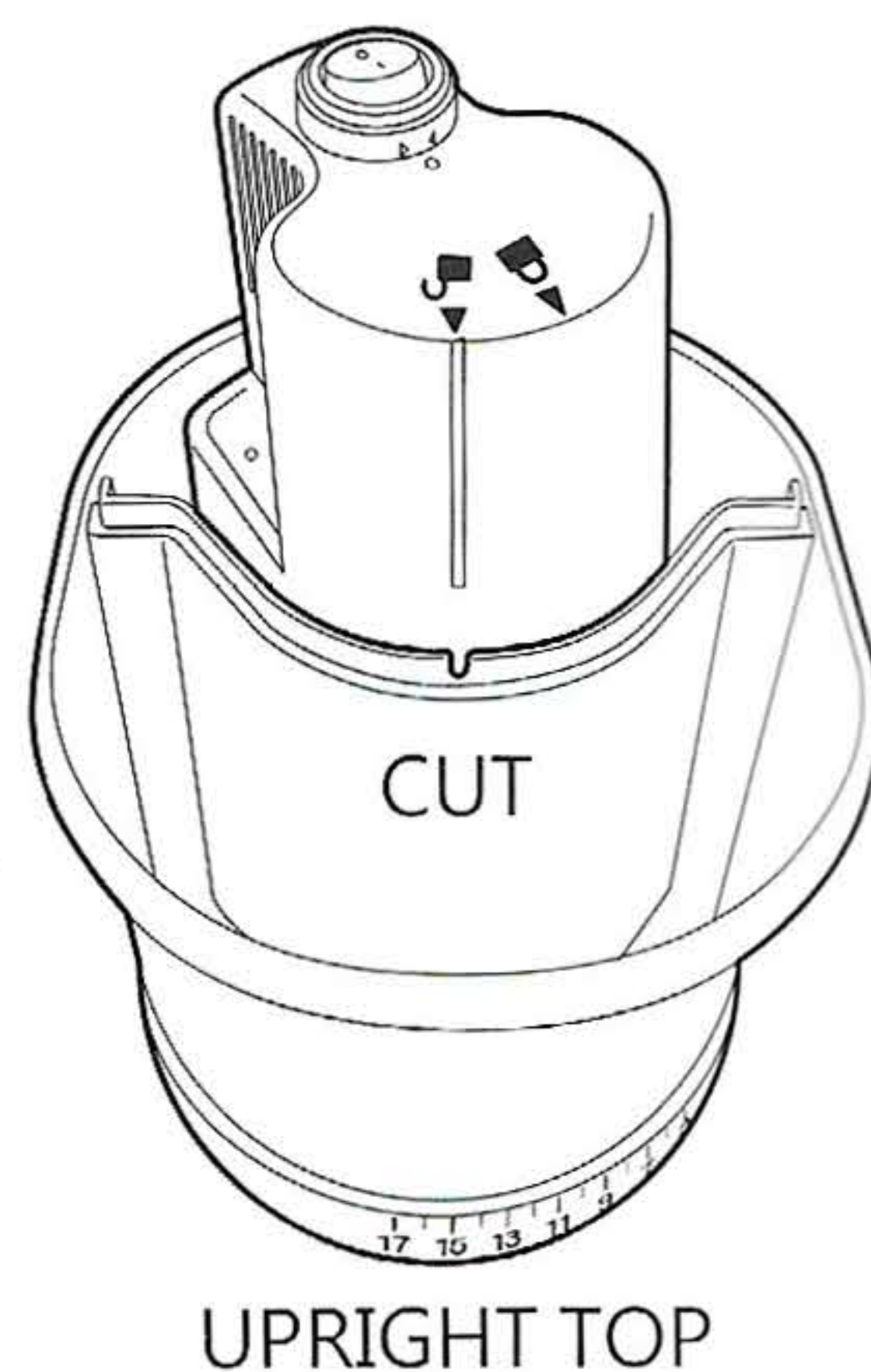
Place the stator, with cove to rib, back into the bottom end of the top then replace the ring.



Turn the top upright for replacing the power unit — guide the "  " symbol on power unit toward the small cut to slip the power unit into the top and then twist the power unit until the "  " symbol links to the small cut.



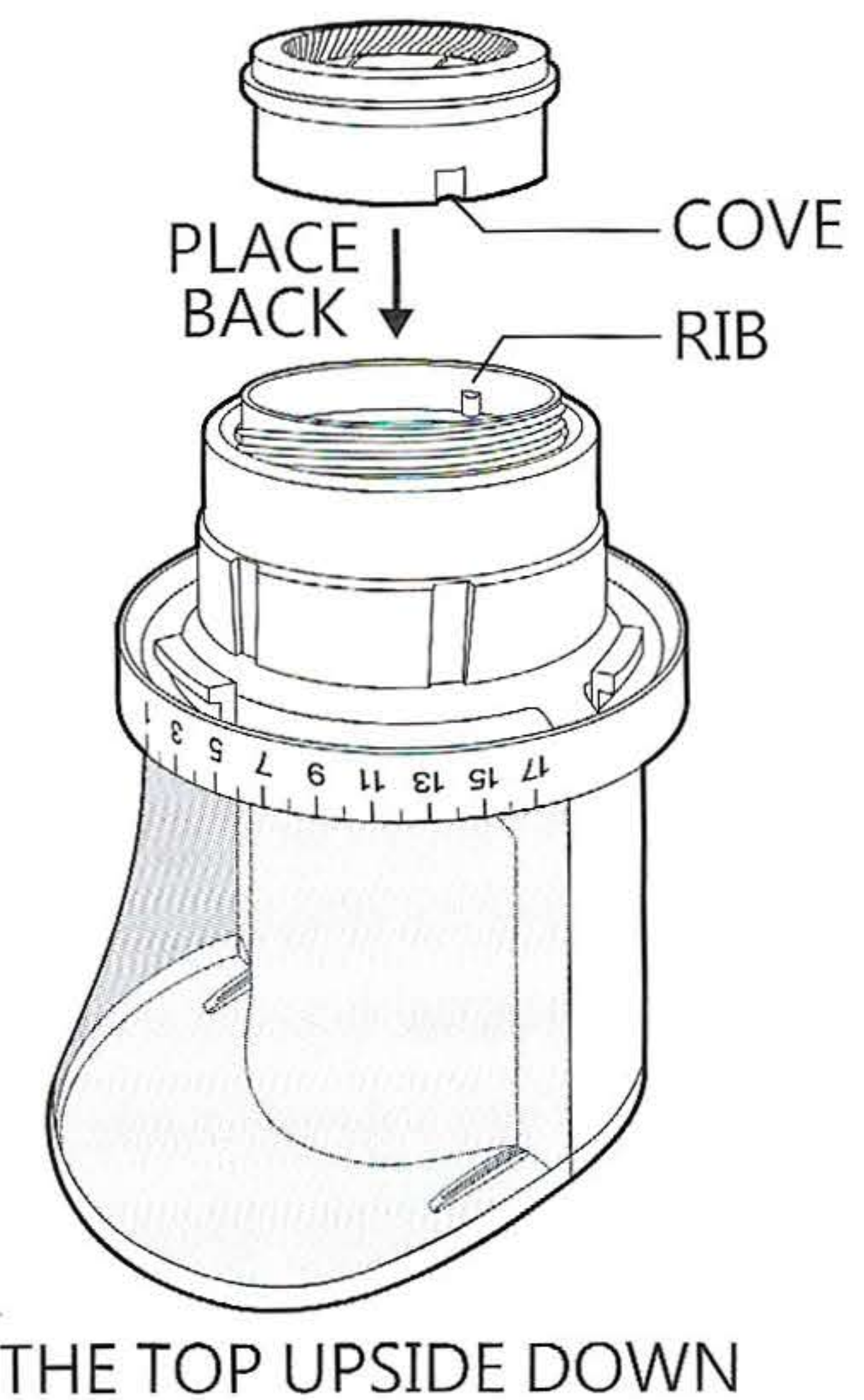

Replace the top lid.



Put The Base Back Together

There is a tapered support in the center of the base inner and simply seat the rotor to the tapered support.

Replace The Top To The Base

Line up the index of "  " with the "  " symbol and keep the top upright to insert into the base, and then twist the top until the "  " points to the "  " symbol.

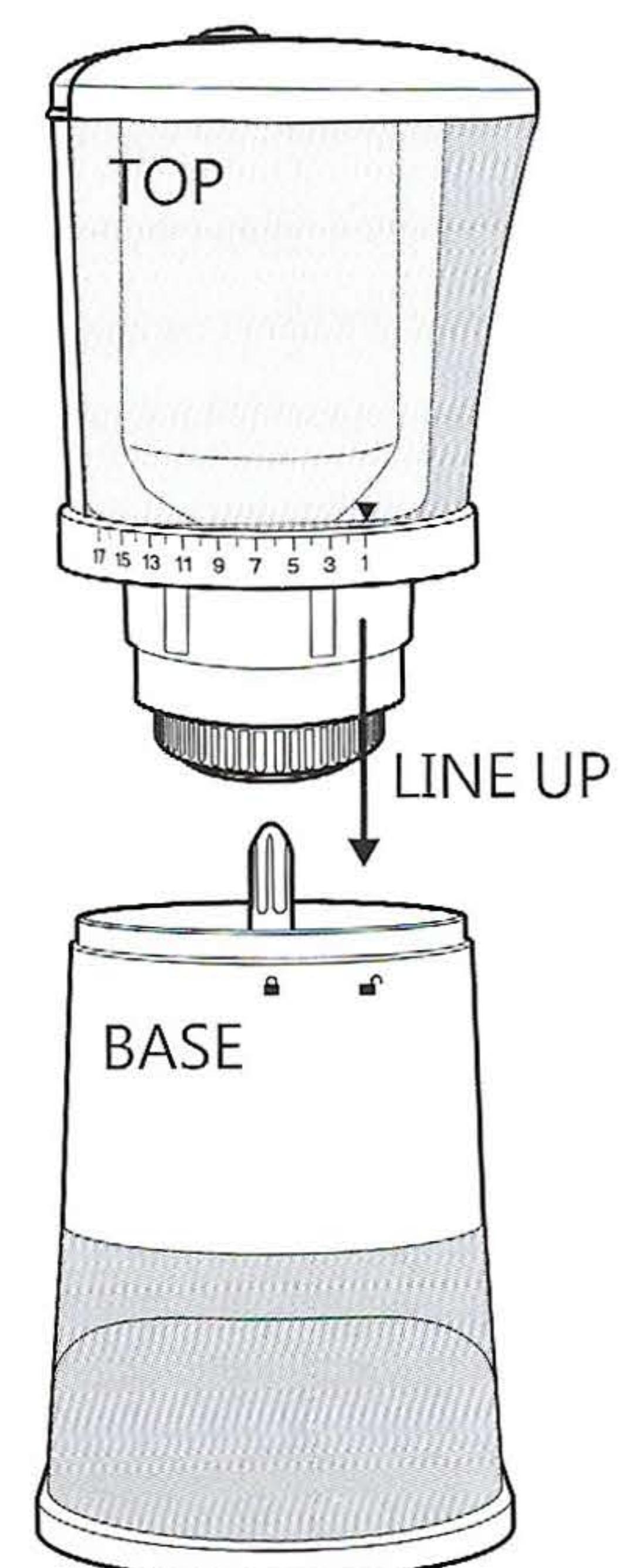

保固訊息

保固期限說明

「全機」一年保固。凡人為因素、異常使用造成的損壞，不在保固範圍之內。

使用注意事項

本機非全自動研磨設備，所以研磨時需要操作人員全程在場以確保正常使用。

若連續研磨超過12分鐘不停，陶瓷刀盤將明顯升溫且

「不利於慢磨條件」，並且馬達可能因此過熱損壞，

已不屬於保固服務範圍。

雖本機設有過載保護機制，但研磨中有發現異物還是需要立即停機排除異物，若持續不排除將可能使馬達受損且屬於異常使用範圍。

陶瓷轉子凹處若未依說明書指示塗抹凡士林(潤滑油)導致研磨品質下降，可向原廠購買零件部品替換。

連續研磨極淺焙超過3分鐘、淺烘焙超過4分鐘、中烘焙超過7分鐘、深烘焙超過12分鐘以上屬於異常使用。

馬達使用注意事項

馬達部位的動力機構不可拆解與水洗。

禁磨生豆、半熟豆、過期豆、生堅果、乾料...等，

僅供研磨烘焙過的咖啡熟豆。

若因人為破壞、毀損、拆解或用於其他用途導致馬達與動力機構損害乃屬異常使用。

刀盤保固注意事項

陶瓷刀盤是工具而非收藏藝品，皆由「半手工方式製成」，

若刀盤出現細紋、結合線、細縫、刮痕或不平整的缺角，

都是屬於製程產生的現象，在正常使用下不會導致崩壞，

亦不影響其研磨功能，請放心使用。

工廠品管將以不影響研磨效果的條件下隨機裝配出貨。

機器拆解或清洗時嚴禁刀盤掉落與碰撞，若人為因素使刀盤受損，亦將不提供保固。

本機所有零件都有可能因使用年限產生老化及故障。

因使用次數與方法略有差異，但所有零件都能單獨購買、更替。

如有疑問請洽經銷商。謝謝。

PATENTED
已獲專利

TW M 534579
CN 201620180117.7
DE 20 2017 100 154
JP 3209445
KR 10-1849873
US 10,405,700

尚 有 多 國 專 利 申 請 中

PATENT PENDING IN OTHER COUNTRIES

Warranty information

Limitations of warranty

We provide one year of full grinder warranty, but the damage caused by improper or misuse use is not covered by the warranty.

Cautions

The grinder is not fully automatic grinding equipment. It needs operator to be within during grinding to ensure normal operation.

If the grinder is continuously ground for more than 12 minutes, the ceramic grinder will heat up significantly and is not conducive for slow grinding conditions. It is recommended to rest for 10 minutes.

If it is continuously ground for more than 30 minutes, it will be abnormally used and the power unit may be damaged.

The grinder is equipped with an overload protection mechanism. However, if other items fall into the grinding, it is necessary to stop immediately to exclude other items. If it is not excluded, the power unit may be damaged and it is an abnormal use.

If the concave part of the ceramic rotor is not oiled and maintained according to the instructions, the grinding quality will be reduced, and the part can be purchased from the local reseller or distributor individually. Continuous grinding of light roasted coffee beans for more than 3 minutes, cinnamon roasted coffee beans for more than 4 minutes, medium roasted coffee beans for more than 7 minutes, and dark roasted coffee beans for more than 12 minutes are all abnormal use.

Safety precautions for power unit

The power unit can not be disassembled and washed.

Grinders are prohibited from grinding raw beans, half-green beans, expired beans, raw nuts, dry materials, etc., only for grinding roasted coffee beans.

Power unit damage caused by improper, misuse use, and disassembly or other uses are an abnormal use.

Ceramic grinder warranty and cautions

The ceramic grinder is not the art collection, but it is made of semi-handmade method, if the grinder has scratch or seems uneven, it is natural phenomenon, and it would affect grinding function, please feel free to use it.

Our staff of quality control will randomly collect and ship ceramic grinder that does not affect grinding performance.

The ceramic grinder is forbidden to drop and knock when it is cleaned or disassembled, the warranty will not be provided when the damage is caused by improper or misuse use.

All parts of the grinder can be malfunction and aged when long time using. Due to different use and usage count, All parts of the grinder can be purchased and replaced individually.

Please send email to Purefresh or ask our local distributor or re-seller if there is further question, thanks for your purchasing.

Purefreshcafe@gmail.com

VER : 004